

KK-P

650Nm

Kettingboutkoppeling
Chain bolt coupling
Kettenbolzkupplung
Accouplement à boulon de chaîne

K-SERIE

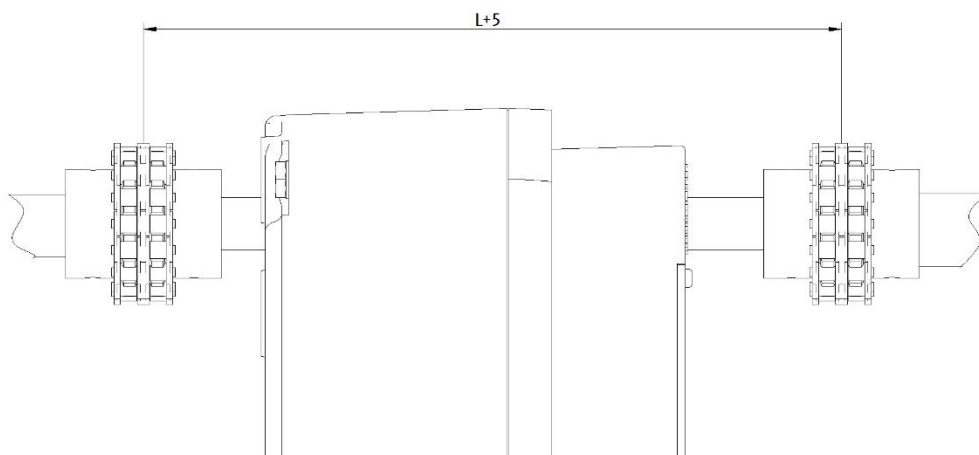
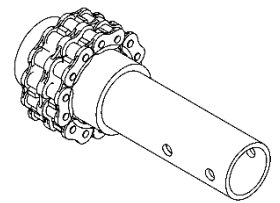
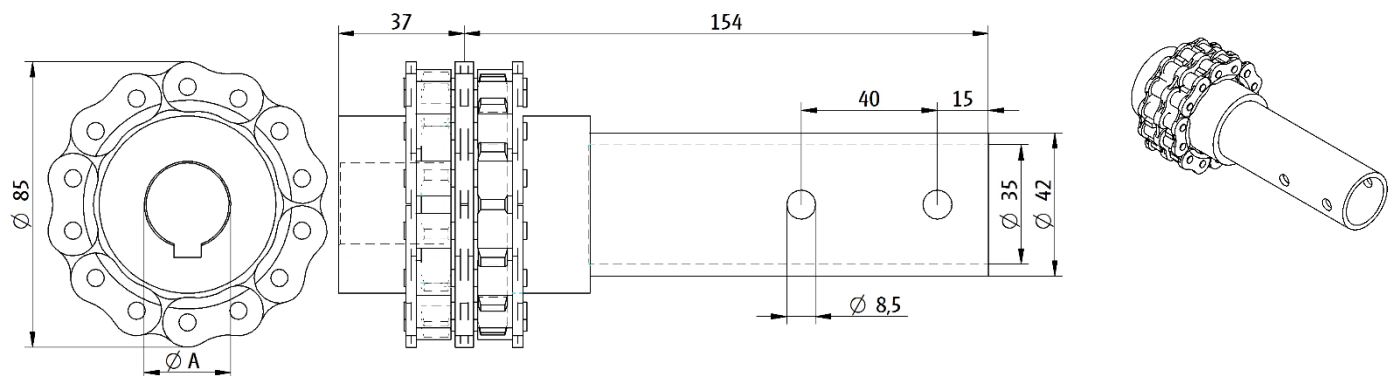

TYPE		KK25-P	KK35-P
M	[Nm]	350	650
ØA	[mm]	24.4	34.5
m	[kg]	1.7	1.6
DIN 8187	[-]	10B2 (5/8" x 3/8")	10B2 (5/8" x 3/8")
Z	[-]	16	16